

H.M. LAND REGISTRY			TITLE NUMBER	
			LA 137823	
ORDNANCE SURVEY PLAN REFERENCE	COUNTY	SHEET	NATIONAL GRID	SECTION
	LANCASHIRE	LXXXII 16		E
Scale: 1/1250 Enlarged from 1/2500			© Crown Copyright 1967.	

COUNTY OF MERSEYSIDE
SEFTON DISTRICT

FORMBY PARISH

The boundaries shown on this plan have been plotted from the Ordnance Survey maps and are subject to revision on survey after the erection of fences

FORMBY BY-PASS

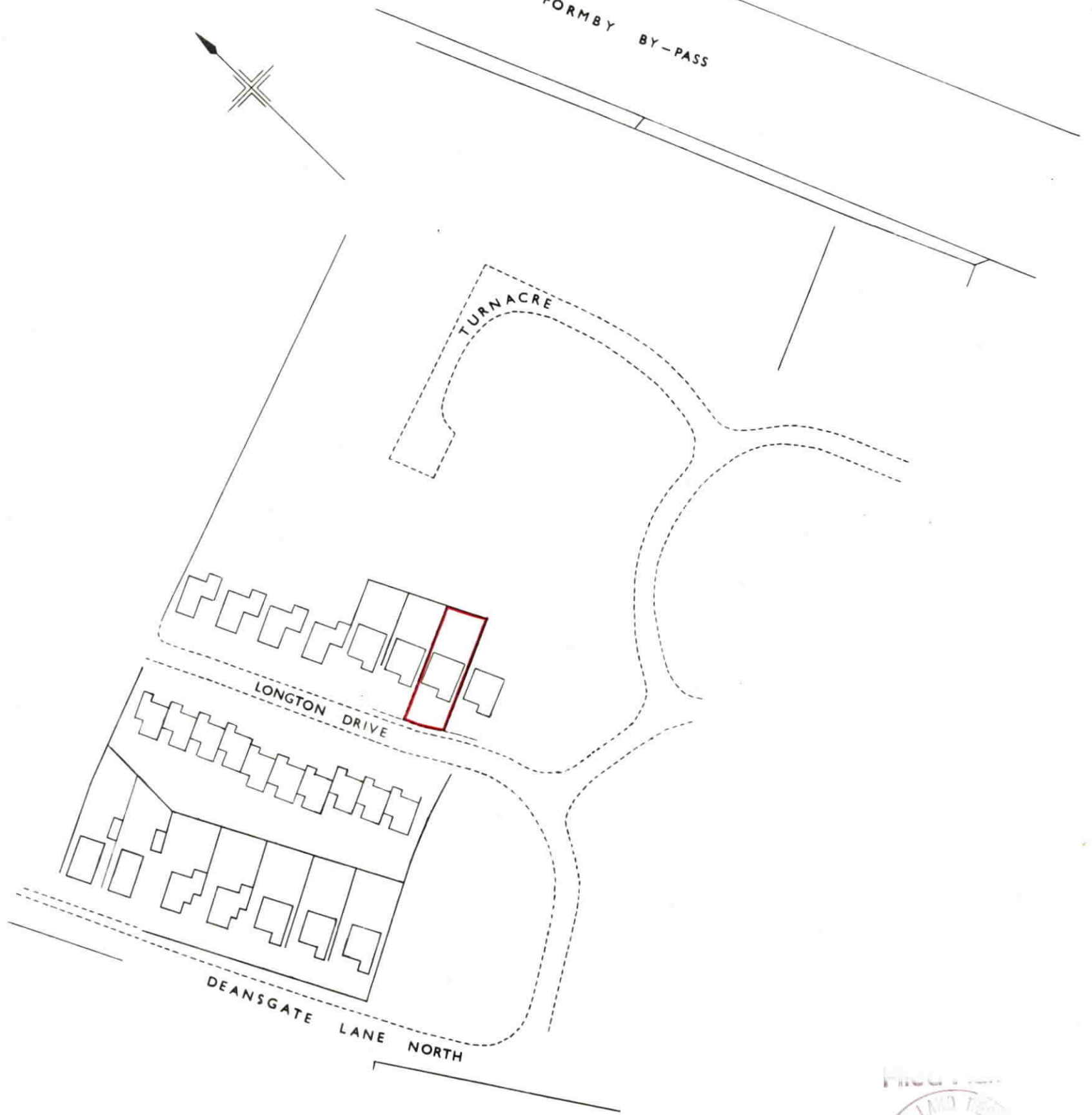

This is a copy of the title plan on 20 OCT 2015 at 09:07:02. This copy does not take account of any application made after that time even if still pending in the Land Registry when this copy was issued.

This copy is not an 'Official Copy' of the title plan. An official copy of the title plan is admissible in evidence in a court to the same extent as the original. A person is entitled to be indemnified by the registrar if he or she suffers loss by reason of a mistake in an official copy. If you want to obtain an official copy, the Land Registry web site explains how to do this.

The Land Registry endeavours to maintain high quality and scale accuracy of title plan images. The quality and accuracy of any print will depend on your printer, your computer and its print settings. This title plan shows the general position, not the exact line, of the boundaries. It may be subject to distortions in scale. Measurements scaled from this plan may not match measurements between the same points on the ground.

This title is dealt with by Land Registry, Birkenhead Office.

© Crown Copyright. Produced by Land Registry. Further reproduction in whole or in part is prohibited without the prior written permission of Ordnance Survey. Licence Number 100026316.